

**ORDER INFORMATION:**

SD2-

- Ports 1 & 2
- 1 (1/8 NPT)
  - 2 (1/4 NPT)
  - 3 (3/8 NPT)
  - 4 (SAE4, □RB)
  - 5 (1/2 NPT)
  - 6 (SAE6, □RB)
  - G6 (G 3/8-19 BSPP)
  - 8 (SAE8, □RB)
  - G8 (G 1/2-14 BSPP)

**Material Option, Pressure Rating**

Pressure Note: Double pressure rating for Port 1 only.

Blank	(6061 Aluminum)	3,000 PSIG
S	(304 Stainless)	5,000 PSIG
S316	(316 Stainless)	5,000 PSIG

INCH  
METRIC

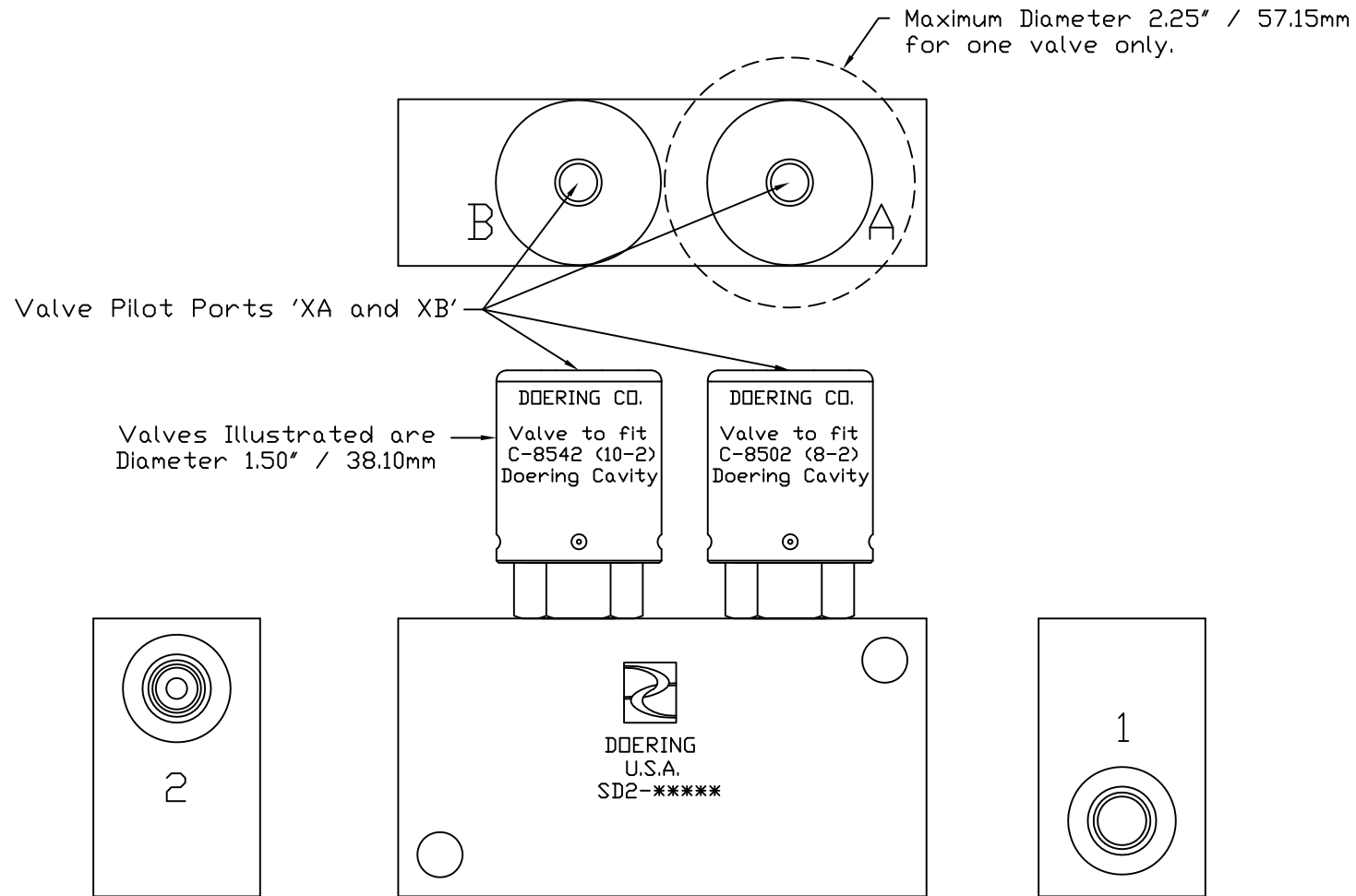

Operational Specifications:

Use No. 1 port for pressure inlet.  
 Use No. 2 port for return (Tank).  
 Assembly may be mounted in any position.  
 Change pilot pressure of valve B to change system pressure when valve B opens to Tank.

Function and Valve Installation Information:

Pilot Both Valves Simultaneously.  
 Cavity A: Install valve for Stage 1 Decompression.  
 Stage 1 Valve opens first due to the high ratio.  
 Stage 1 Valve installed in Cavity A has the smallest orifice and provides the decompression function.  
 Cavity B: Install valve for Stage 2, Higher Flow  
 Stage 2 Valve opens when system pressure drops to a point determined by the pilot ratio. Pilot pressure times the ratio determines the approximate system pressure, opening point of this valve.

Please call our applications engineering department for additional assistance.

The SD2-\*\*\*\*\* is the part number for housing only. In addition, specify the valves.